

Hypertherm®

Duramax™ MRT Retrofit torch

For Powermax1000/1250

MRT machine torch consumables



Mechanized consumables

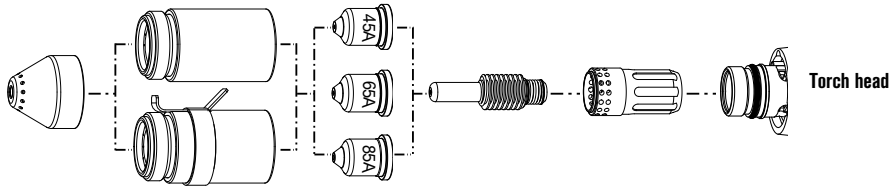

	Shield	Retaining cap	Nozzle	Electrode	Swirl ring
45 A	220817*	220854	220941*	220842*	220857
65 A	220817*	220854	220819*	220842*	220857
85 A	220817*	220854	220816*	220842*	220857
Ohmic		220953			

Unshielded consumables

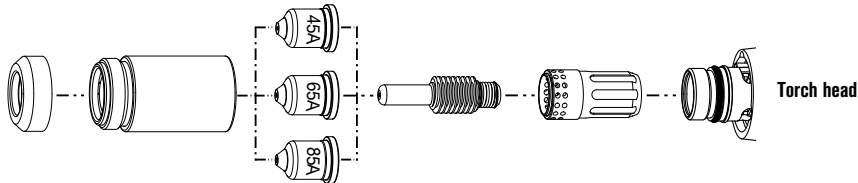

	Shield/Deflector	Retaining cap	Nozzle	Electrode	Swirl ring
45 A	220955	220854	220941*	220842*	220857
65 A	220955	220854	220819*	220842*	220857
85 A	220955	220854	220816*	220842*	220857

Gouging consumables

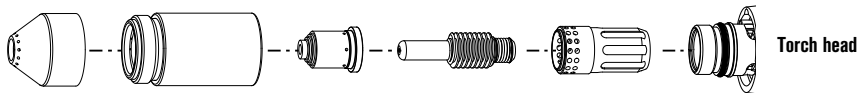

	Shield	Retaining cap	Nozzle	Electrode	Swirl ring
65 A/85 A	220798	220854	220797*	220842*	220857

FineCut consumables

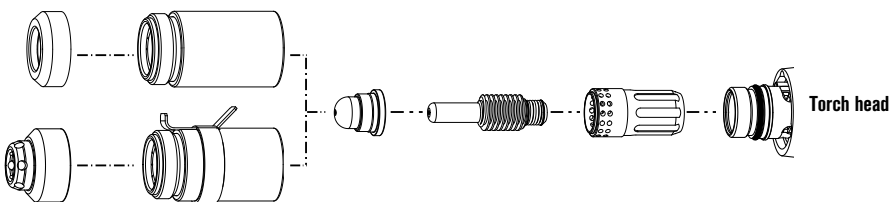

	Shield/Deflector	Retaining cap	Nozzle	Electrode	Swirl ring
45 A	220955	220854	220930*	220842*	220857
Ohmic	220948	220953			

All-in-one and FineCut kits available. Visit www.hypertherm.com/consumablekits or see pages 87 – 88 for options.

* Consumables available in multiple packaging options, see page 87 for bulk package information.

Hypertherm, Powermax, FineCut, Conical Flow and Spring Start are trademarks of Hypertherm, Inc. and may be registered in the United States and/or other countries.



TECHNOLOGIES

FineCut®
Dielectric shield
Vented shield
Conical Flow™
Spring Start™

Duramax™ MRT

MRT hand torch assembly

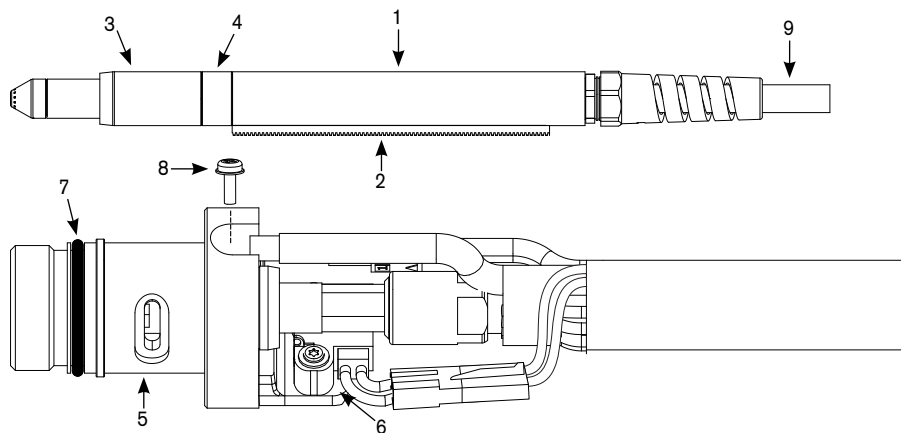

MRT assembly

Part number	Description
228790*	MRT Machine torch assembly with 25' (7.6 m) lead
228791*	MRT Machine torch assembly with 50' (15.2 m) lead
1. 228737	Kit: M65/M85/MRT positioning sleeve
2. 228738	Kit: M65/M85/MRT removable gear rack
3. 228735	Kit: M65/M65m/M85/M85m/MRT front mounting sleeve
4. 228736	Kit: M65/M65m/M85/M85m/MRT adapter ring (coupler)
5. 228793	Kit: MRT torch main body replacement
6. 228720	Kit: Cap-sensor switch replacement
7. 058519	O-ring
8. 075504	Pilot terminal screw
9. 228786	Kit: MRT torch lead replacement, 25' (7.6 m)
9. 228787	Kit: MRT torch lead replacement, 50' (15.2 m)
128650	Remote start pendant for machine torch, 25' (7.63 m)
128651	Remote start pendant for machine torch, 50' (15.24 m)
128772	Kit: ETR connector repair (regional repair centers only)

*Assembly includes a variety of Duramax consumables

